



Trendy Fittings with Passion

Range 1

ALUMINUM FITTINGS



www.domusitalya.com

info@domusitalya.com

Galeon by **D.I.**
Made In China



Trendy Fittings with Passion

Part 1
DOOR HINGES



www.domusitalya.com

info@domusitalya.com

Galeon^{by} D.I.
Made In China

DOOR HINGES

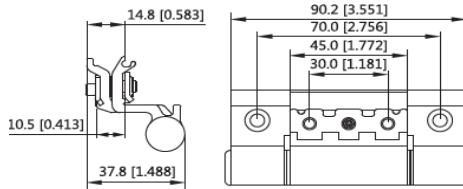

Code
AH201JLHYA01

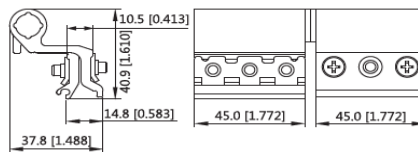

Code
AH202JLHYA02

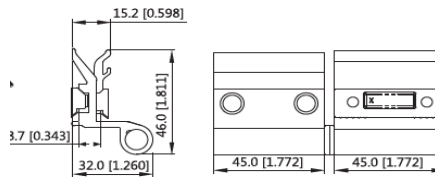

Code
AH203JLHYA05

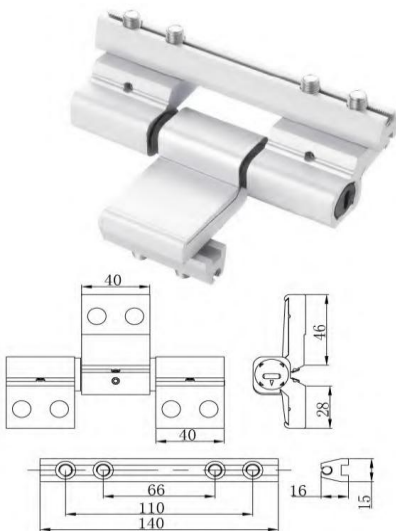

Code
AH204WS4090

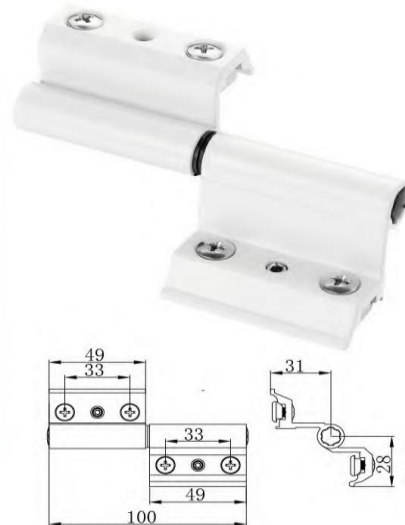

Code
AH205WS4100

DOOR HINGES

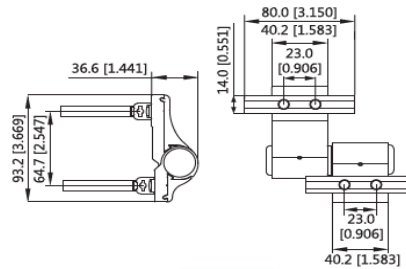

Code
AH206JLHYB03

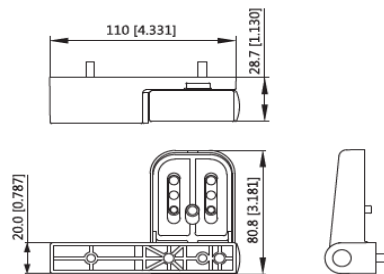

Code
AH207JLHYB04

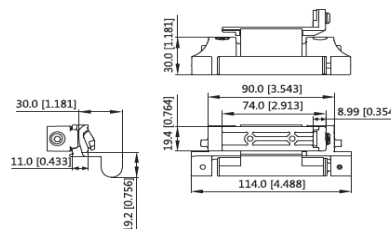

Code
AH208JLHYA09

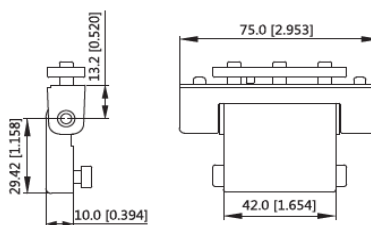

Code
AH209JLHYB02

DOOR HINGES

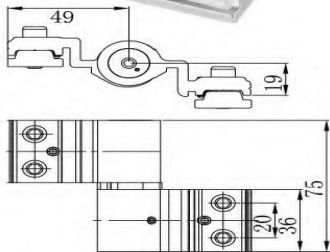

Code

AH210WS4050

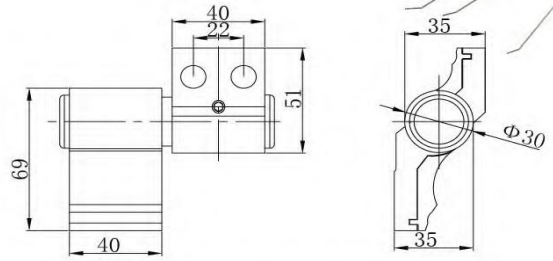

Code

AH211WS4060

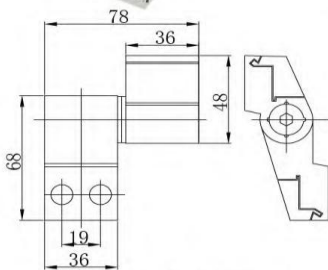

Code

AH212WS4070

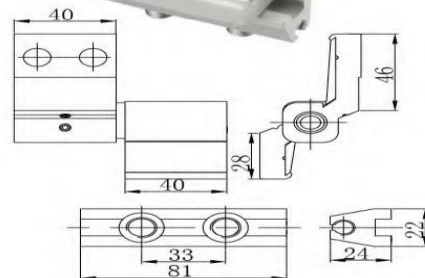

Code

AH213WS4080

DOOR HINGES



Code
AH214TY194
95 mm



Code
AH215TY87
100 mm



Code
AH216TY200
120 mm



Code
AH217TY86
100 mm



Code
AH218TYA133A
132 mm



Code
AH219TYA133B
83 mm

DOOR HINGES

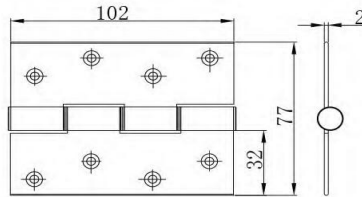

Code
AH220WS4020

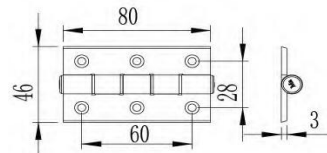

Code
AH221WS4480

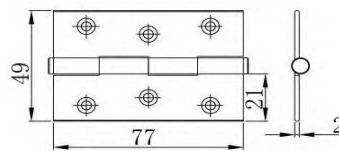

Code
AH222WS4430

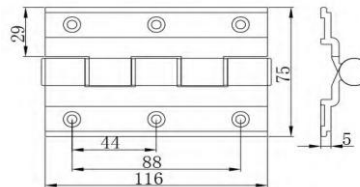

Code
AH223WS4040

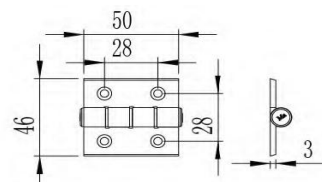

Code
AH224WS4470

DOOR HINGES

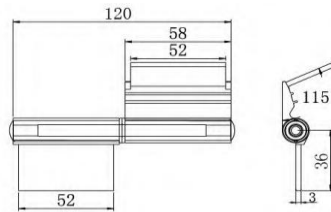

Code
AH225WS4351

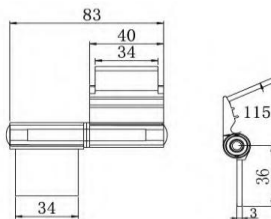

Code
AH226WS4350

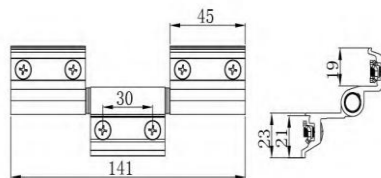

Code
AH227WS4320

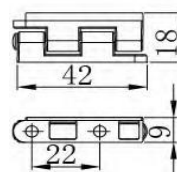

Code
AH228WS4450



Trendy Fittings with Passion

Part 2
BOLTS & CATCHES



www.domusitalya.com

info@domusitalya.com

Galeon^{by} D.I.
Made In China

DOOR BOLTS

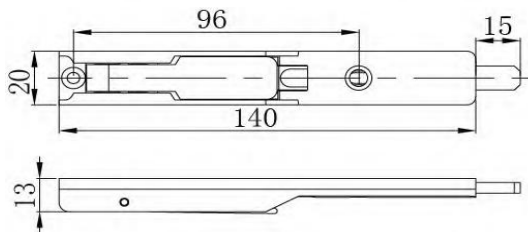

Code
AH411WS36401

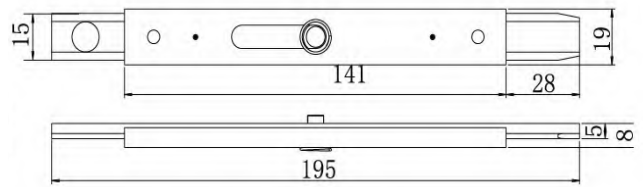

Code
AH417WS36411

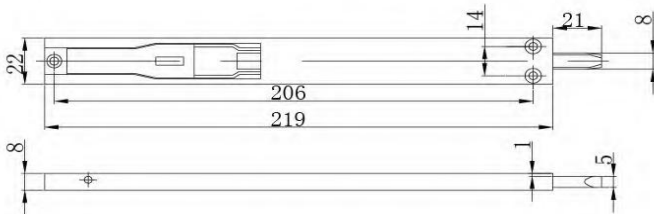
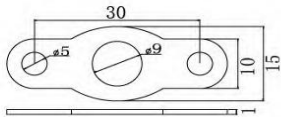

Code
AH403WS3646

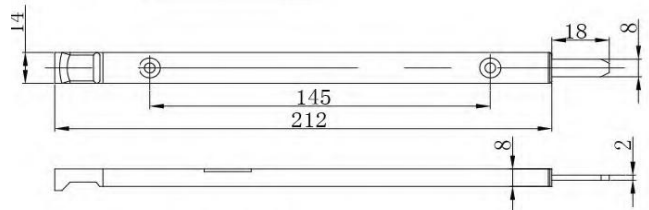
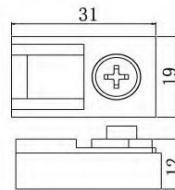

Code
AH405WS3645

WINDOW CATCHES

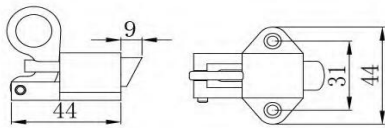

Code
AH431WS3652

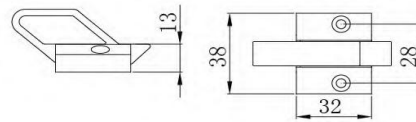

Code
AH438WS3653

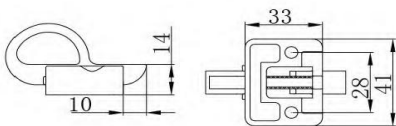

Code
AH418WS3654

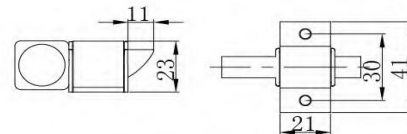

Code
AH421WS3651



Trendy Fittings with Passion

Part 3
ROLLERS



www.domusitalya.com

info@domusitalya.com



Galeon by D.I.
Made In China

ROLLERS

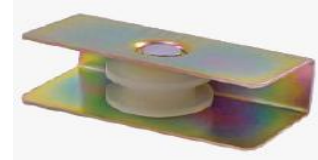

Code

AH301YTC10015



Code

AH302ULI330



Code

AH303YTC10014B



Code

AH304YTC10014A

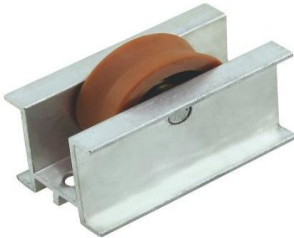

Code

AH310YTC10014



Code

AH312YTC10014



Code

AH313YTC10016A



Code

AH314YTC10016B

ROLLERS



Code

AH307YTC1002



Code

AH308YTC1013



Code

AH309YTC10013A



Code

AH315YTC10013



Code

AH311YTC1001



Code

AH316YTC10012



Code

AH313YTC10017



Code

AH314YTC10017A

ROLLERS



Code

AH315YTC10014E



Code

AH317YTC0028



Code

AH318YTC0032



Code

AH319YTC0033

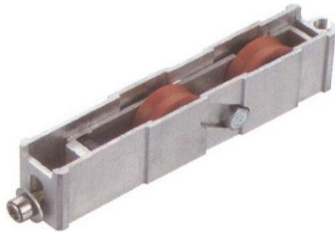

Code

AH320YTC0035



Code

AH321YTC0034



Code

AH322YTC0044



Code

AH323YTC0039

ROLLERS



Code

AH324YTC0037

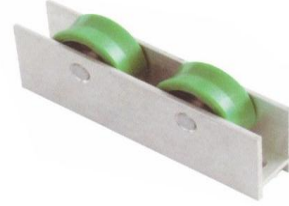

Code

AH325YTC0045



Code

AH326YTC0054

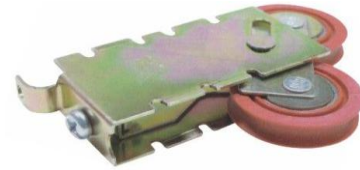

Code

AH327YTC0046



Code

AH328YTC0050



Code

AH329YTC0059



Code

AH330YTC00501



Code

AH331YTC0052



Trendy Fittings with Passion

Part 4
FITTINGS



www.domusitalya.com

info@domusitalya.com

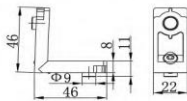

Galeon^{by} D.I.
Made In China

FITTINGS

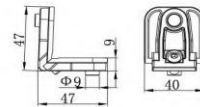

Code

AH351SWC5010



Code

AH352SWC5020

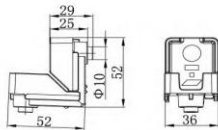

Code

AH353SWC5140

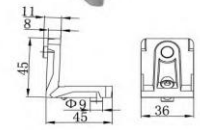

Code

AH354SWC5070

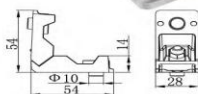

Code

AH355SWC5170

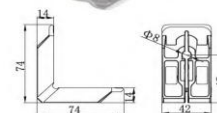

Code

AH356SWC5200

FITTINGS

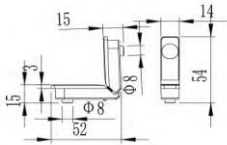

Code

AH357SWC5015

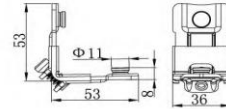

Code

AH358SWC5210

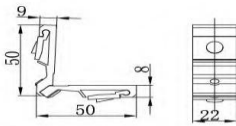

Code

AH359SWC5230

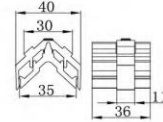

Code

AH360SWC5250

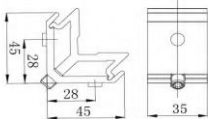

Code

AH361SWC5250

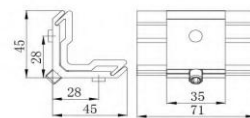

Code

AH362SWC5224

FITTINGS

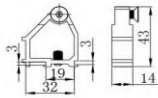

Code
AH363SWC5280

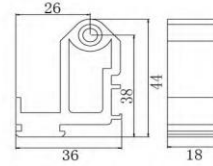

Code
AH364SWC5310

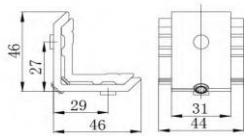

Code
AH365SWC5223

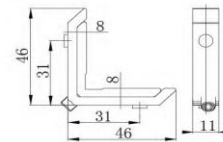

Code
AH366SWC5221

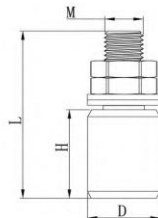

Code
AH367SWC6020

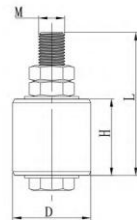

Code
AH368SWC6040



Trendy Fittings with Passion

Part 5
FRICTION STAYS



www.domusitalya.com

info@domusitalya.com

Galeon^{by} D.I.
Made In China

FRICION STAYS FOR WINDOWS

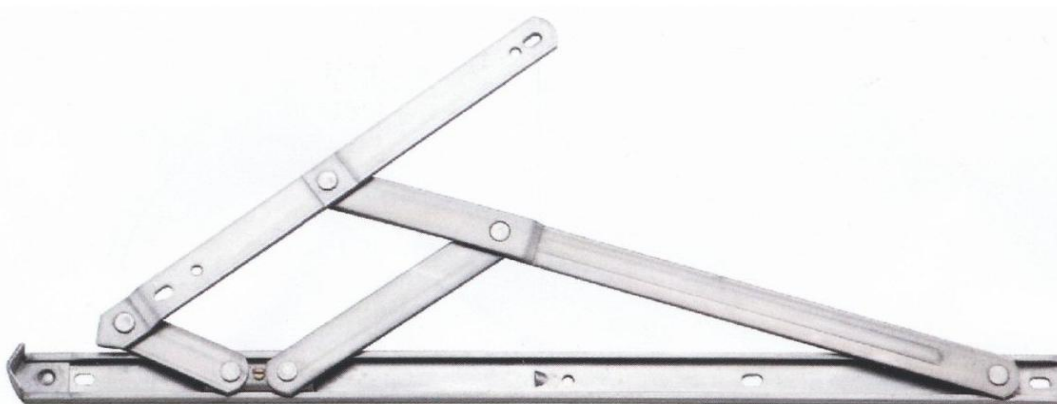

Code	Thickness	Channel	Length		Material
AH2225161820	1.6 mm	18 mm	200 mm	8"	SUS 304
AH2225161825	1.6 mm	18 mm	250 mm	10"	SUS 304
AH2225182230	1.8 mm	22 mm	300 mm	12"	SUS 304
AH2225182235	1.8 mm	22 mm	350 mm	14"	SUS 304
AH2225182240	1.8 mm	22 mm	400 mm	16"	SUS 304
AH2225182245	1.8 mm	22 mm	450 mm	18"	SUS 304
AH2225202750	2.0 mm	27 mm	500 mm	20"	SUS 304
AH2225202755	2.0 mm	27 mm	550 mm	22"	SUS 304
AH2225202760	2.0 mm	27 mm	600 mm	24"	SUS 304
AH2225202765	2.0 mm	27 mm	650 mm	26"	SUS 304
AH2225202770	2.0 mm	27 mm	700 mm	28"	SUS 304



Code	Thickness	Channel	Length		Material
AH2230121520	1.2 mm	15 mm	200 mm	8"	SUS 304
AH2230121525	1.2 mm	15 mm	250 mm	10"	SUS 304
AH2230121530	1.2 mm	15 mm	300 mm	12"	SUS 304
AH2230121535	1.2 mm	15 mm	350 mm	14"	SUS 304